

Female Female Bobbins

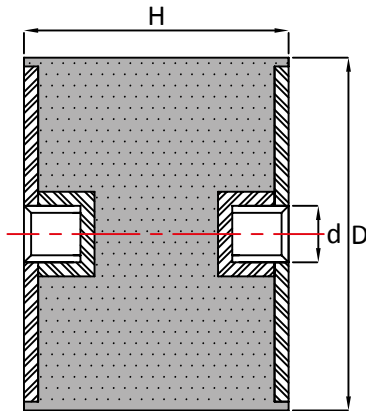

Part No	D x H	d	45° Shore A	60° Shore A	70° Shore A	mm
1515FF04	15 x 15	M4	6.1	11.2	15.8	1.3
2015FF06	20 x 15	M6	7.9	14.8	20.5	1.0
2020FF06	20 x 20	M6	7.4	13.7	18.9	1.6
2025FF06	20 x 25	M6	7.0	12.6	17.8	2.2
2030FF06	20 x 30	M6	5.6	10.0	14.1	2.6
2515FF06	25 x 15	M6	15.7	30.0	42.0	1.0
2520FF06	25 x 20	M6	16.8	31.0	41.0	1.6
2525FF06	25 x 25	M6	13.0	25.0	34.0	2.1
2525FF08	25 x 25	M8	13.0	25.0	34.0	2.1
2530FF08	25 x 30	M8	10.4	20.7	30.4	2.6
3020FF08	30 x 20	M8	15.7	30.0	40.0	1.2
3025FF08	30 x 25	M8	18.0	31.0	42.0	2.1
3030FF08	30 x 30	M8	15.8	30.0	40.0	2.6
3035FF08	30 x 35	M8	15.0	29.0	39.0	3.1
3040FF08	30 x 40	M8	14.7	29.0	38.0	3.6
4020FF08	40 x 20	M8	32.0	61.0	88.0	1.2
4030FF08	40 x 30	M8	35.0	65.0	91.0	2.6
4030FF10	40 x 30	M10	35.0	65.0	91.0	2.6
4035FF08	40 x 35	M8	27.0	54.0	79.0	2.5
4035FF10	40 x 35	M10	27.0	54.0	79.0	2.5
4040FF08	40 x 40	M8	31.0	57.0	78.0	3.6
4040FF10	40 x 40	M10	31.0	57.0	78.0	3.6
4045FF10	40 x 45	M10	30.0	56.0	77.0	4.1
5025FF10	50 x 25	M10	76.0	140.0	193.0	2.1
5030FF10	50 x 30	M10	71.0	131.0	180.0	2.5
5035FF10	50 x 35	M10	62.0	115.0	158.0	3.0
5040FF10	50 x 40	M10	51.0	95.0	132.0	3.5
5045FF08	50 x 45	M8	46.0	86.0	120.0	4.0
5045FF10	50 x 45	M10	46.0	86.0	120.0	4.0
5050FF10	50 x 50	M10	42.0	86.0	109.0	4.5
5060FF10	50 x 60	M10	38.0	80.0	105.0	5.4
6035FF12	60 x 35	M12	111.0	260.0	285.0	3.1

Part No	D x H	d	45° Shore A	60° Shore A	70° Shore A	mm
6040FF10	60 x 40	M10	103.0	192.0	261.0	3.5
6040FF12	60 x 40	M12	103.0	192.0	261.0	3.5
6045FF10	60 x 45	M10	93.0	174.0	241.0	4.0
6045FF12	60 x 45	M12	93.0	174.0	241.0	4.0
6050FF12	60 x 50	M12	84.0	156.0	215.0	4.5
6535FF12	65 x 35	M12	135.0	252.0	348.0	3.0
7030FF10	70 x 30	M10	178.0	330.0	450.0	2.4
7035FF10	70 x 35	M10	157.0	312.0	430.0	2.9
7035FF12	70 x 35	M12	157.0	312.0	430.0	2.9
7040FF10	70 x 40	M10	145.0	270.0	375.0	3.4
7045FF10	70 x 45	M10	130.0	240.0	327.0	3.9
7045FF12	70 x 45	M12	130.0	240.0	327.0	3.9
7050FF10	70 x 50	M10	120.0	220.0	305.0	4.4
7050FF12	70 x 50	M12	120.0	220.0	305.0	4.4
7060FF12	70 x 60	M12	118.0	218.0	300.0	5.4
7070FF10	70 x 70	M10	113.0	210.0	290.0	6.4
7540FF12	75 x 40	M12	157.0	290.0	400.0	3.4
7545FF12	75 x 45	M12	155.0	285.0	392.0	3.9
7550FF12	75 x 50	M12	150.0	280.0	390.0	4.4
7555FF12	75 x 55	M12	130.0	245.0	340.0	4.9
7560FF12	75 x 60	M12	115.0	190.0	300.0	5.2
9575FF12	95 x 75	M12	225.0	450.0	661.5	6.7
9575FF16	95 x 75	M16	225.0	450.0	661.5	6.7
10040FF16	100 x 40	M16	390.0	700.0	970.0	3.2
10045FF16	100 x 45	M16	345.0	625.0	865.0	3.7
10050FF16	100 x 50	M16	305.0	550.0	760.0	4.2
10055FF16	100 x 55	M16	280.0	520.0	720.0	4.7
10060FF16	100 x 60	M16	270.0	490.0	680.0	5.2
100100FF16	100 x 100	M16	175.0	305.0	430.0	9.2
10575FF16	105 x 75	M16	325	650	955.5	6.7
12075FF16	120 x 75	M16	390	780	1146.6	6.7
15075FF20	150 x 75	M20	405.0	725.0	1010.0	6.7

Max compression load in Kg deflection in mm.

This information is for guidance only. Customers are recommended to contact us for further technical information on products and applications.

We reserve the right to alter specifications or withdraw products without notice.